

# PARKING HOIST

2 POST - BASE PLATE



AA-2PFP45



CE approved

## MOTOREX features

- ✓ Floor plate dual (2) point manual release.
- ✓ 2-Stage arms
- ✓ Aluminium shell motor prevents overhead.
- ✓ Hydraulic pressure pre-setting preventing from lifting vehicle with exceeding rated loads
- ✓ Routine testing with 115% dynamic and 150% static loading
- ✓ 8-fold-profile posts, 5 times strength than the traditional posts
- ✓ Stable, reliable & easy maintenance



## NZ Installations

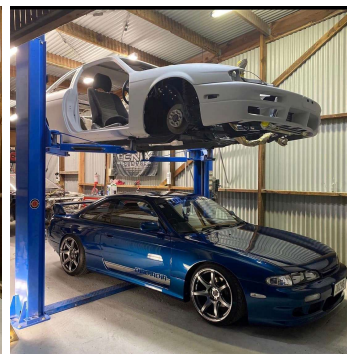
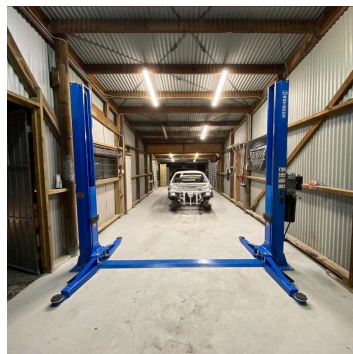
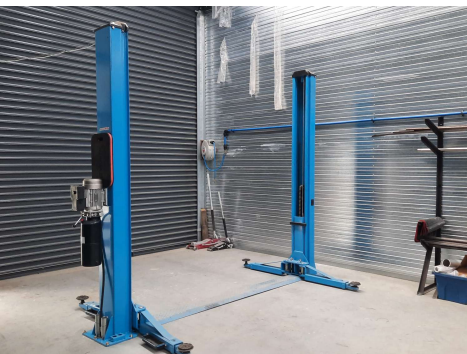

## Technical Specification

**Lifting Capacity:** 4.5T

**Max Lifting Height:**

77 5/16 inches with truck adaptor,  
71 inches without truck adaptor

**Min Height:** 3 5/8 inches

**Drive Through:** 98 7/16 inches

**Lifting Time:** ≤50s

**Lowering Time:** ≥20s≤50s

**Motor Power:** 3 HP

**Motor Voltage:** 220 v

**Rated Frequency:** 60 hz

**Phase:** 1ph

**Column Thickness of Steel:** 5mm

**Carriage Thickness of Steel:** 6mm

**Arms Thickness of Steel:** 6mm

**Cable Diameter:** 0.366"

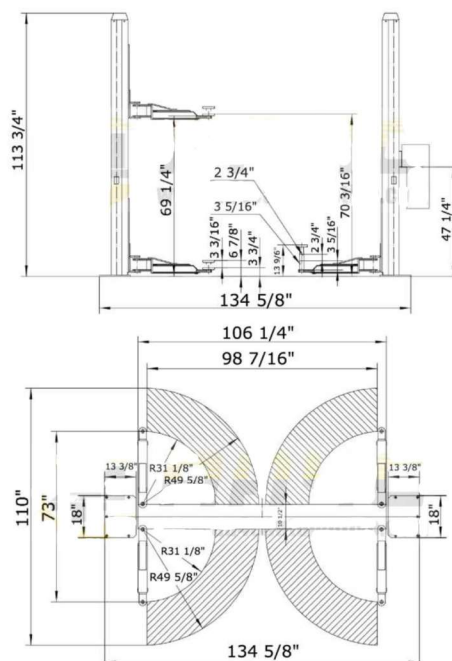

**MOTOREX  
HOIST**

Since 2008



**TRUSTED  
VEHICLE LIFT  
SOLUTION  
PROVIDER**

[ SALES |  
INSTALLATION |  
PARTS & SERVICE ]

**CALL:  
021-2627162**

**READY  
STOCK**



**NATIONWIDE  
DELIVERY**

**NZ  
OWNED**  
Since 2008



[www.motorexhoist.com](http://www.motorexhoist.com)